

Cod: 80FLAFIL...

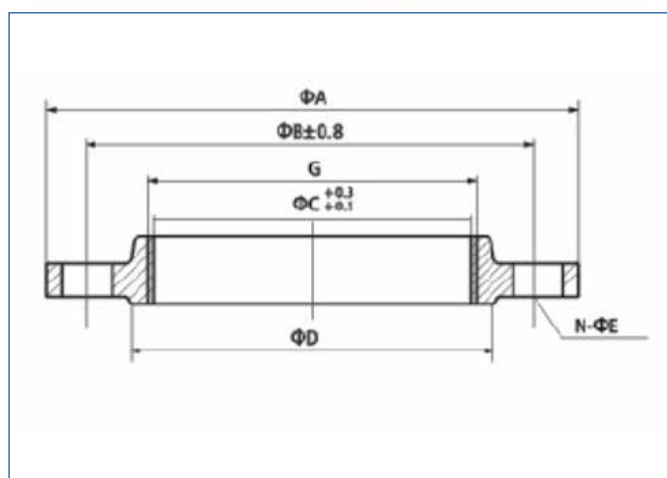

Descrizione

- Flangia filettata
- Rivestimento epossidico a polvere
- Verniciatura RAL 5010



Standards

- Conforme alla EN 545
- Conforme al D.M. 174

Tabella dimensionale

| | DN | ØA | ØB | ØC | ØD | DN | DN | ØE |
|----|--------|-----|-----|-------|-----|--------|----|----|
| 50 | 1" | 165 | 125 | 30,3 | 99 | 1" | 4 | 19 |
| | 1" 1/4 | 165 | 125 | 39 | 99 | 1" 1/4 | 4 | 19 |
| | 1" 1/2 | 165 | 125 | 44,9 | 99 | 1" 1/2 | 4 | 19 |
| | 1" 3/4 | 165 | 125 | 50,9 | 99 | 1" 3/4 | 4 | 19 |
| | 2" | 165 | 125 | 56,7 | 99 | 2" | 4 | 19 |
| | 2" 1/2 | 165 | 125 | 72,3 | 99 | 2" 1/2 | 4 | 19 |
| | 3" | 165 | 125 | 85 | 99 | 3" | 4 | 19 |
| | 3" 1/2 | 165 | 125 | 97,4 | 99 | 3" 1/2 | 4 | 19 |
| | 4" | 165 | 125 | 110,1 | 99 | 4" | 4 | 19 |
| | 4" 1/2 | 165 | 125 | 122,8 | 99 | 4" 1/2 | 4 | 19 |
| 60 | 1" | 175 | 135 | 30,3 | 108 | 1" | 4 | 19 |
| | 1" 1/4 | 175 | 135 | 39 | 108 | 1" 1/4 | 4 | 19 |
| | 1" 1/2 | 175 | 135 | 44,9 | 108 | 1" 1/2 | 4 | 19 |
| | 1" 3/4 | 175 | 135 | 50,9 | 108 | 1" 3/4 | 4 | 19 |
| | 2" | 175 | 135 | 56,7 | 108 | 2" | 4 | 19 |
| | 2" 1/2 | 175 | 135 | 72,3 | 108 | 2" 1/2 | 4 | 19 |
| | 3" | 175 | 135 | 85 | 108 | 3" | 4 | 19 |
| | 3" 1/2 | 175 | 135 | 97,4 | 108 | 3" 1/2 | 4 | 19 |
| | 4" | 175 | 135 | 110,1 | 108 | 4" | 4 | 19 |
| | 4" 1/2 | 175 | 135 | 122,8 | 108 | 4" 1/2 | 4 | 19 |
| | 5" | 175 | 135 | 135,5 | 118 | 5" | 4 | 19 |
| | 6" | 175 | 135 | 160,9 | 108 | 6" | 4 | 19 |

| | DN | ØA | ØB | ØC | ØD | DN | DN | ØE |
|----|--------|-----|-----|-------|-----|--------|----|----|
| 65 | 1" | 185 | 145 | 30,3 | 118 | 1" | 4 | 19 |
| | 1" 1/4 | 185 | 145 | 39 | 118 | 1" 1/4 | 4 | 19 |
| | 1" 1/2 | 185 | 145 | 44,9 | 118 | 1" 1/2 | 4 | 19 |
| | 1" 3/4 | 185 | 145 | 50,9 | 118 | 1" 3/4 | 4 | 19 |
| | 2" | 185 | 145 | 56,7 | 118 | 2" | 4 | 19 |
| | 2" 1/2 | 175 | 145 | 72,3 | 118 | 2" 1/2 | 4 | 19 |
| | 3" | 175 | 145 | 85 | 118 | 3" | 4 | 19 |
| | 3" 1/2 | 175 | 145 | 97,4 | 118 | 3" 1/2 | 4 | 19 |
| | 4" | 175 | 145 | 110,1 | 118 | 4" | 4 | 19 |
| | 4" 1/2 | 175 | 145 | 122,8 | 118 | 4" 1/2 | 4 | 19 |
| | 5" | 175 | 145 | 135,5 | 118 | 5" | 4 | 19 |
| | 6" | 175 | 145 | 160,9 | 118 | 6" | 4 | 19 |